

# ILLI 24V SPOT

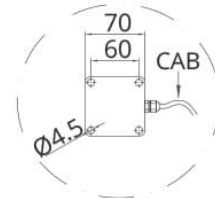
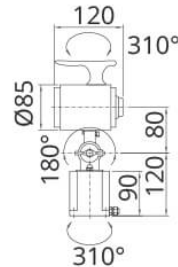

Cable without Plug

## APPLICATIONS

Lamps LED SPOT - Nik Light - Led Security - are equipped with powerful LED and are specially designed for lighting small working places or for controlling working cycles running on CAD-CAM machines. Protection class IP65 - IP67, 3W-12W - 20W - 28W luminous efficiency, 24V-AC/DC and 100÷240V-AC power supply available.

The special system for arm and head adjusting, makes these products adaptable to any lighting requirement: workbenches, walls of small working cabins, inside CNC or traditional machine tools.

## VOLTAGE:

24V-AC/DC with LED driver built-in the base and 2-pole cable

## STANDARD:

30° LED Module

## OPTIONAL ACCESSORIES:

neutral glass, clamps, angle plate and magnetic base

---

## STANDARD 60° LED MODULE

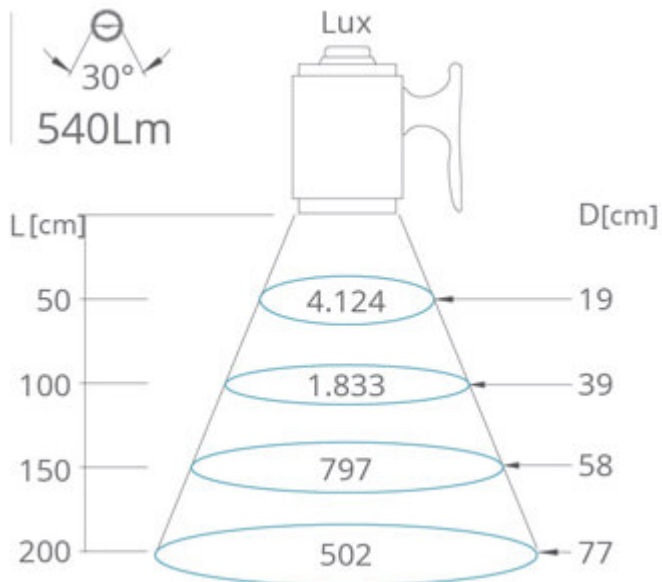

## WXLED

1Wx3

## CABLE.MT

CV02-1,80

## KG

1,70

---