

IP65

3W - 540Lm

6.000°K - 40.000h

RoHS RAEE CONFORMITY



cavo senza spina
cable without plug

CARATTERISTICHE

Fino all'85% di risparmio energetico
Basso calore
Zero manutenzione
Testa orientabile in alluminio estruso con vetro ad alta resistenza
Bracci facilmente regolabili
Resistente ai lubro-refrigeranti
Direttive 2006/95/CE, 2004/108/CE e 2006/42/CE come previsto dalla Normativa UNI EN 1837

FEATURES

*Up to 85% energy saving
Low performing heat
Zero maintenance
Adjustable extruded aluminium head with high resistance glass
Easily adjustable articulated arms or vibration-resistant flexible arms
Resistant to coolants and lubricants
Complies with Directives 2006/95/EC, 2004/108/EC and 2006/42/EC as required by Normative UNI EN 1837*

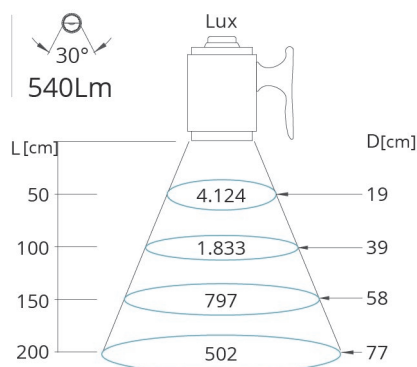

ILLI 24V-AC/DC - 3W - IP65

Alimentazione:

24V-AC/DC con alimentatore integrato nella base e cavo bipolare

Voltage:

24V-AC/DC with LED driver built-in the base and 2-pole cable

Standard:

Modulo Led con angolo 30°

Standard:

30° LED Module

Accessori opzionali:

vetro, morsetto, staffa e base magnetica di fissaggio

Optional Accessories:

neutral glass, clamps, angle plate and magnetic base.

24V-AC/DC

ART.

CODE

VIN

WxLed

cable.mt

Kg

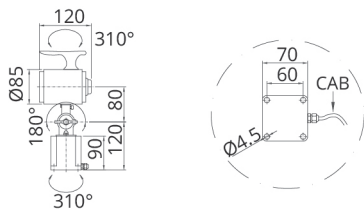

IN03 L30-S-24V-AC/DC

02.01.2.30.03.1

24V AC/DC

1Wx3

CV02-1,80

1,70

24V-AC/DC

ART.

CODE

VIN

WxLed

cable.mt

Kg

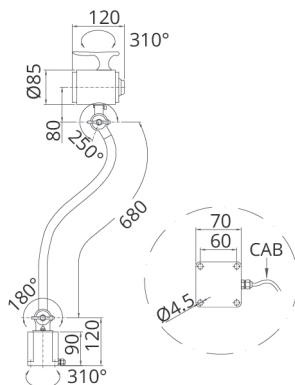

IN03 L30-F680-24V-AC/DC

02.04.2.30.03.1

24V AC/DC

1Wx3

CV02-1,80

2,70

RICAMBI STANDARD E OPTIONAL STANDARD AND OPTIONAL SPARE PARTS

NEUTRAL GLASS



ART
CODE

FIL 65N
02.07.008.0

CLAMP

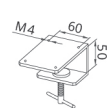

JC 02
00.11.010.1

MAGNETIC BASE

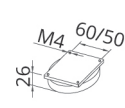

JM 01
00.11.014.5

ANGLE PLATE

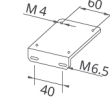

JL 02
00.11.012.1

SCATOLA MADRE MASTER BOX



Qty: 6 pcs
Dimensions: 32x50x52 cm
Weight: 13/15 Kg