

MINI Z 100÷240V-AC

IP65

3W - 480Lm

6.000°K - 40.000h

RoHS RAEE CONFORMITY



ZOOM FOCUS
10°÷80°



cavo con spina
Euro A10
cable with Euro A10
plug

CARATTERISTICHE

Fino all'85% di risparmio energetico
Basso calore
Zero manutenzione
Testa orientabile in alluminio estruso con vetro ad alta resistenza
Bracci facilmente regolabili
Resistente ai lubro-refrigeranti
Direttive 2006/95/CE, 2004/108/CE e 2006/42/CE come previsto dalla Normativa UNI EN 1837

FEATURES

*Up to 85% energy saving
Low performing heat
Zero maintenance
Technopolymer adjustable head with high resistance glass
Easily adjustable and vibration-resistant flexible arms
Resistant to coolants and lubricants
Complies with Directives 2006/95/EC, 2004/108/EC and 2006/42/EC as required by Normative UNI EN 1837*

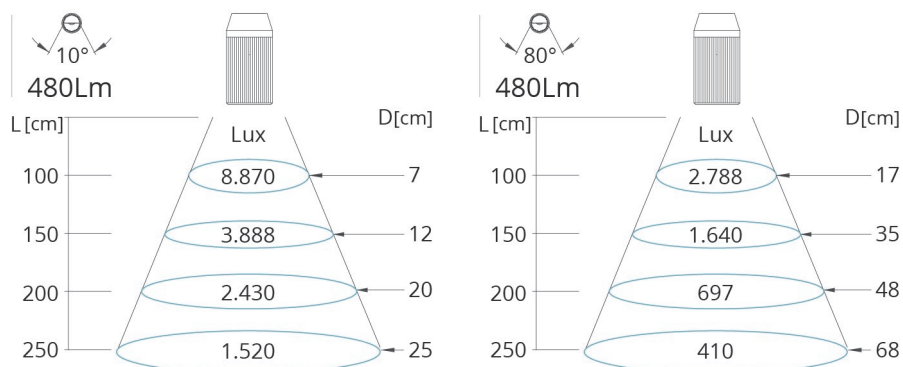

MINI Z 100÷240V-AC - 3W - IP65

100÷240V-AC

Zoom:
| angolo illuminazione variabile da 10° a 80°

Zoom:
| adjustable lighting angle from 10° to 80°

Alimentazione:
| 100÷240V-AC con alimentatore integrato nella base e cavo con spina Euro 10A

Voltage:
| 100÷240V-AC with LED driver built-in the base and cable with 10A Euro plug

Accessori opzionali:
| morsetto, staffa e base magnetica di fissaggio

Optional Accessories:
| mounting clamp, angle plate and magnetic base.

100÷240V-AC	ART.	CODE	VIN	WxLed	cabl.mt	Kg
-------------	------	------	-----	-------	---------	----

MN03 LZ-F700-100÷240V-AC 06.01.1.01.03.1 100÷240V AC 3Wx1 SP04-1,80 1,10

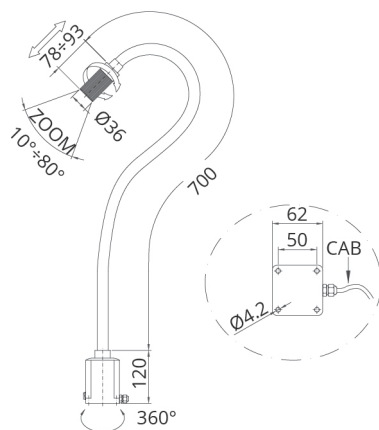

RICAMBI STANDARD E OPTIONAL STANDARD AND OPTIONAL SPARE PARTS

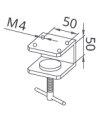
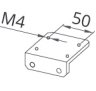
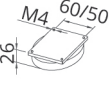
	CLAMP	ANGLE PLATE	MAGNETIC BASE
			
ART	JC 03	JL 05	JM 01
CODE	00.11.011.1	00.11.013.1	00.11.014.5

SCATOLA MADRE MASTER BOX



Qty: 5 pcs
Dimensions: 45x25x62 cm
Weight: 9 Kg

THE DATA ARE NOT BINDING AND CAN BE CHANGED WITHOUT ADVANCE NOTICE.