

ILLI 100-240V SPOT

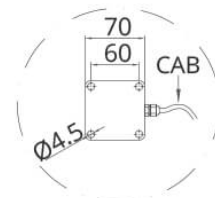
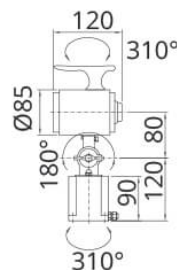

Cable with Shuko Plug

APPLICATIONS

Lamps LED SPOT - Nik Light - Led Security - are equipped with powerful LED and are specially designed for lighting small working places or for controlling working cycles running on CAD-CAM machines. Protection class IP65 - IP67, 3W-12W - 20W - 28W luminous efficiency, 24V-AC/DC and 100÷240V-AC power supply available.

The special system for arm and head adjusting, makes these products adaptable to any lighting requirement: workbenches, walls of small working cabins, inside CNC or traditional machine tools.

VOLTAGE:

100÷240V-AC with LED driver built-in the base and cable with Schuko plug

STANDARD:

30° LED Module

OPTIONAL ACCESSORIES:

neutral glass, clamps, angle plate and magnetic base

30° LED MODULE

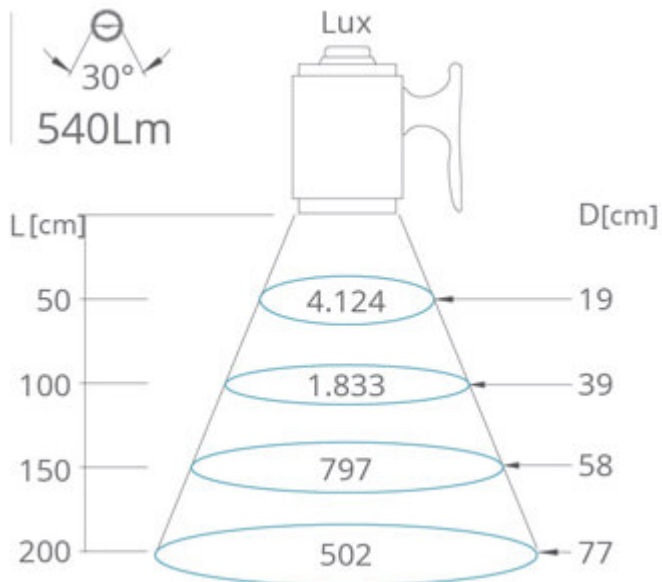

WXLED

1Wx3

CABLE.MT

SP02-1,80

KG

1,70
